

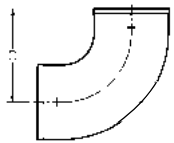

**NO HUB ASA GROUP 022**

**BENDS & SWEEPS**

**Quarter Bend**



SIZE	
1 1/2	5
2	6
3	8
4	

**Quarter Bend w/ 2" Side Opening**

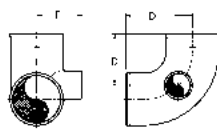

SIZE
3
4

**Quarter Bend w/ 2" Heel Opening**

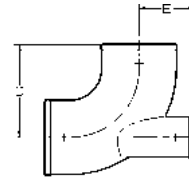

SIZE
3
4

**Quarter Bend Extended Low Heel Inlet**

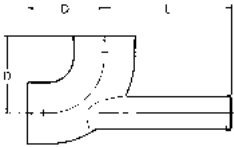

SIZE
3 x 2
4 x 2

**Reducing Quarter Bend (Fla. Style)**

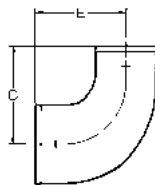

SIZE
4 x 3

**Tap Short Quarter Bend**

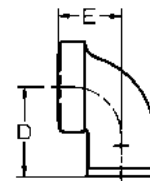

SIZE
1 1/2 x 1 1/2
2 x 1 1/4
2 x 1 1/2
2 x 2

**Long Sweep**

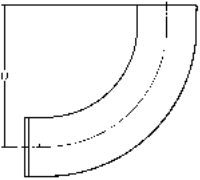

SIZE
1 1/2
2
3
4 x 3
4
5
6

**Long Quarter Bend**

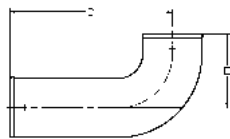

Size-Lgth
2-12
2-14
2-16
2-18
3-12
3-18
4-12

**Short Sweep**

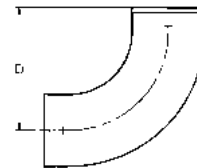

SIZE	
2	8
3	10
4	12
5	15
6	

**BRASS CLEANOUT PLUGS**

**Type A Low Square Head**

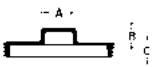

IPS	A	B	C
1-1/4	11/16	5/16	13/32
1-1/2	3/4	5/16	3/8
2	15/16	5/16	7/16
2-1/2	1	5/16	7/16
3	1-1/8	7/16	15/32
3-1/2	1-1/8	3/8	1/2
4	1-3/32	3/8	1/2
5	1-3/8	7/16	1/2
6	1-3/8	1/2	5/8
8	1-5/8	1/2	3/4
10*	2	1	3/4

\*Type "O"

**Type S Plain Countersunk**

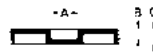

IPS	A	B	C
1-1/2	11/16	5/16	3/8
2	3/4	5/16	7/16
2-1/2	3/4	5/16	7/16
3	7/8	5/16	15/32
3-1/2	15/16	3/8	1/2
4	7/8	3/8	1/2
5	1-1/8	3/8	1/2
6	1-7/16	1/2	5/8
8	1-7/16	1/2	3/4



**NO HUB ASA GROUP 022  
BENDS, TEES**

**Double Quarter Bend**

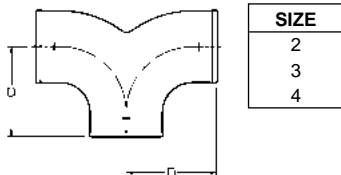

**Fifth Bend**

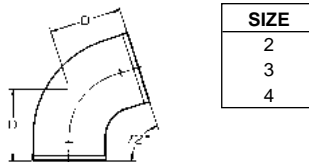

**Sixth Bend**

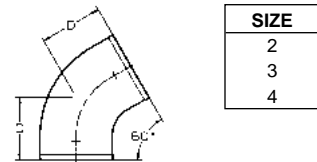

**Eighth Bend**

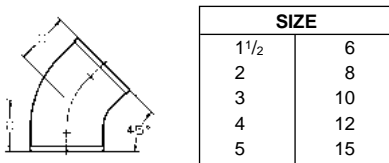

**Long Eighth Bend**

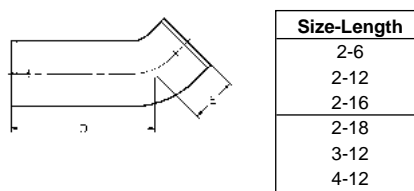

**Sixteenth Bend**

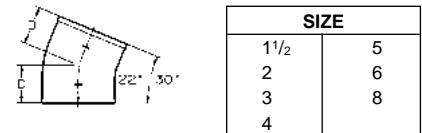

**San Tee**

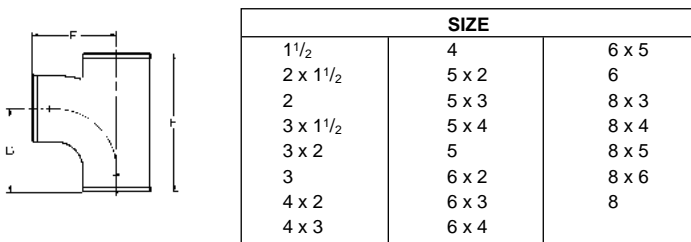

**San Tap Tee**

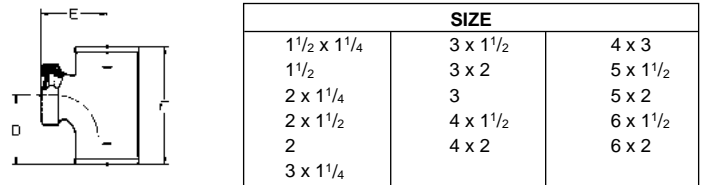

**San Tee**

(w/ 2" 90° Side Opening on Center)

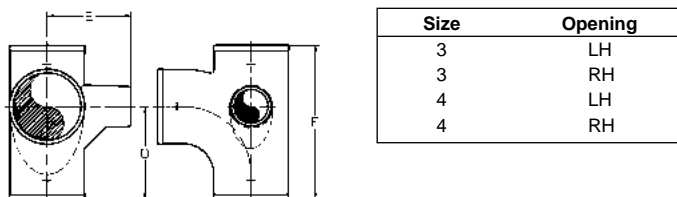

**San Tee**

(w/ 2" 90° Side Opening Above Center)  
New Orleans Code

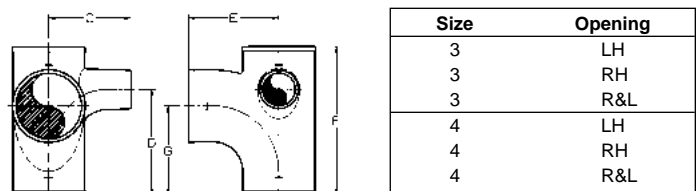



**NO HUB ASA GROUP 022**  
**TEES & WYE'S, COMBINATIONS AND Y'S**

**SAN TEE**

(w/2" 45° Side Opening Above Center)  
 New Orleans Code

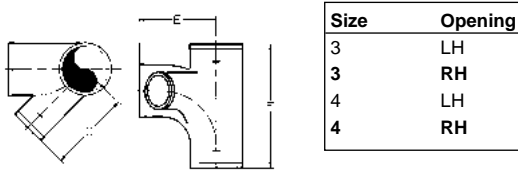

**HORIZONTAL TWIN TAP TEE**

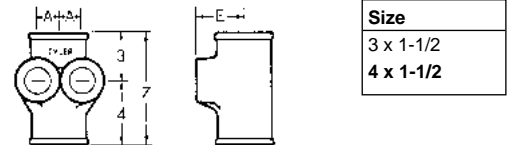

**DOUBLE VERTICAL SAN TAP TEE**

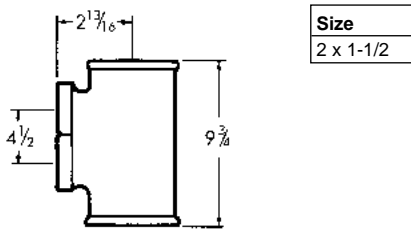

**SAN TAP TEE (w/Tap on Side)**

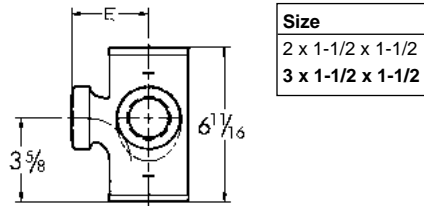

**WYE**

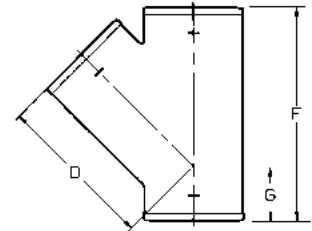

**DOUBLE WYE**

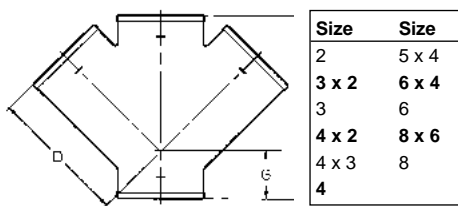

**TAP WYE**

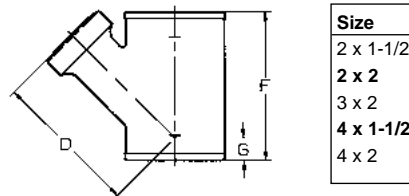

Size	Size	Size
1-1/2	5 x 4	8 x 5
2	5	8 x 6
3 x 1-1/2	6 x 2	8
3 x 2	6 x 3	10 x 4
3	6 x 4	10 x 6
4 x 2	6 x 5	10 x 8
4 x 3	6	10
4	8 x 2	12
5 x 2	8 x 3	15
5 x 3	8 x 4	

**DOUBLE COMBINATION**

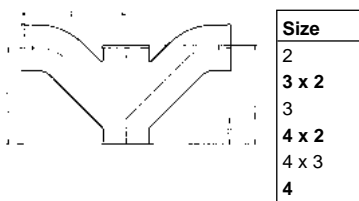

**COMBINATION**

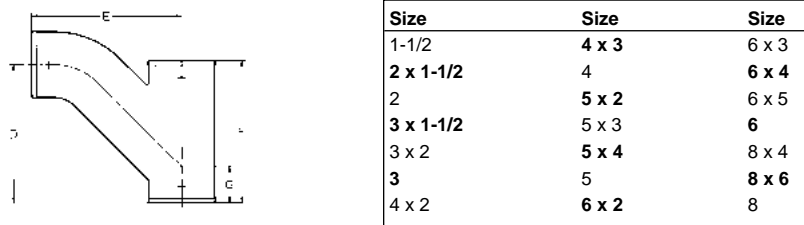



**NO HUB ASA GROUP 022  
CROSSES, TEES, FERRULES, REDUCERS, ADAPTERS & PLUGS**

**SAN CROSS**

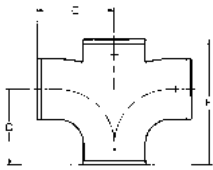

Size	Size
1-1/2	4
2	5 x 4
3 x 2	6 x 4
3	6
4 x 2	8 x 4
4 x 3	

**SAN CROSS  
(w/2" 90° Opening Above Center)  
New Orleans Code  
(No Baffle)**

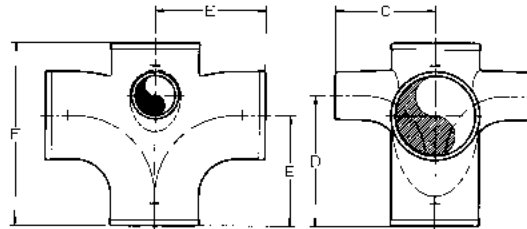

Size	(Inlets)
4	(1)
4	(2)

**SAN CROSS  
(with two 2" 45° San Openings-Same Side)  
New Orleans Code  
(No Baffle)**

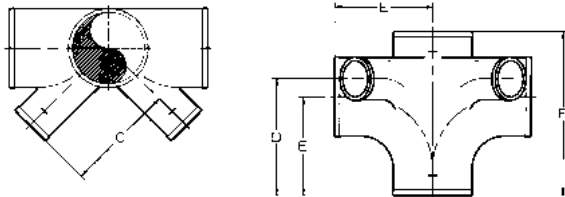

Size
3
4

**SAN TAP CROSS  
(No Baffle)**

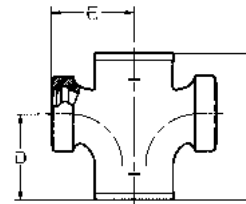

Size	Size
1-1/2 x 1-1/2	3 x 2
2 x 1-1/4	4 x 1-1/2
2 x 1-1/2	4 x 2
2 x 2	5 x 1-1/2
3 x 1-1/2	6 x 1-1/2

**TEST TEE  
(Less Plug)**

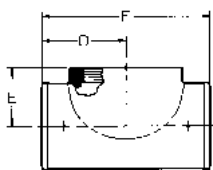

Size IPS	Size-IPS
2-2	6-6
3-3	8-8
4-4	10-10
5-5	

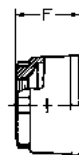
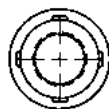

**FERRULE  
(Less Plug)**

Size
2 x 1-1/2
3 x 2-1/2
4 x 3-1/2
5 x 4
6 x 5
8 x 6

**FERRULE  
w/Type A Plug**

Size
2 x 1-1/2
3 x 2-1/2
4 x 3-1/2
5 x 4
6 x 5
8 x 6

**BLIND PLUG**

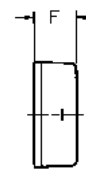

Size	Size
1-1/2	6
2	8
3	10
4	12
5	15

**INCREASER-REDUCER**

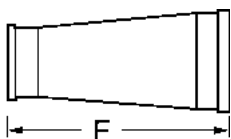

Size
3 x 4

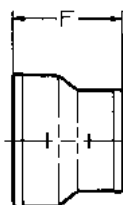

**SHORT REDUCER**

Size	Size	Size	Size
2 x 1-1/2	6 x 2	8 x 5	12 x 8
3 x 1-1/2	6 x 3	8 x 6	12 x 10
3 x 2	6 x 4	10 x 4	15 x 4
4 x 2	6 x 5	10 x 6	15 x 6
4 x 3	8 x 2	10 x 8	15 x 8
5 x 3	8 x 3	12 x 4	15 x 10
5 x 4	8 x 4	12 x 6	15 x 12



**NO-HUB ASA GROUP 022**  
**TRAPS, FIGURE FITTINGS, SPECIALTIES & TRAPS**

**P-TRAP**

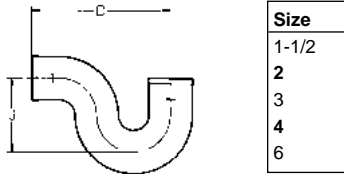

**LONG P-TRAP**

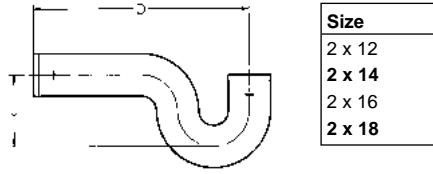

**REDUCING P-TRAP**

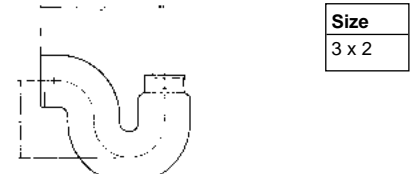

**DEEP SEAL P-TRAP**

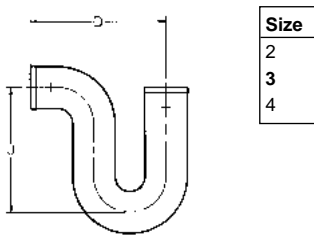

**P-TRAP**  
**w/1/2" Primer Tap**

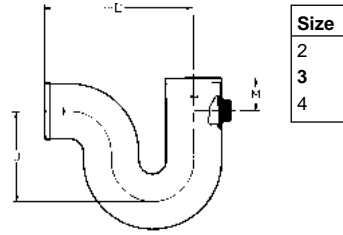

**TAP P-TRAP**

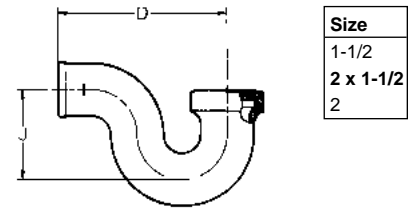

**RUNNING TRAP W/TWO 4" VENTS**

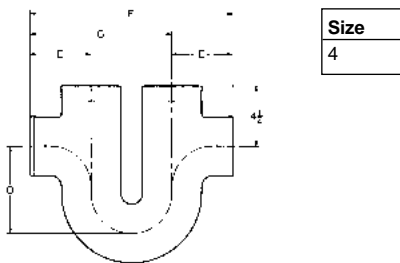

**RUNNING TRAP W/4" SINGLE VENT**

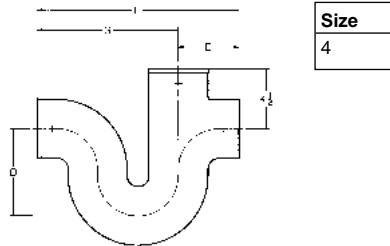

**HUB ADAPTER**  
**No-Hub by SV Ty-Seal®**

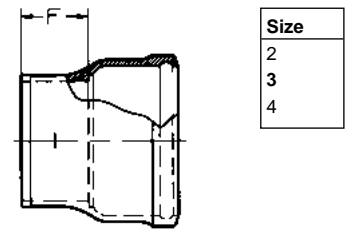

**TAP ADAPTER**

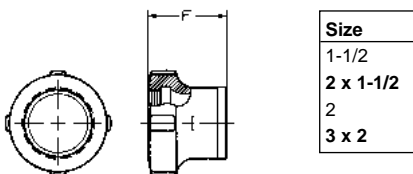

**9-480 CLOSET FLANGE**  
**(Slot & Notch)**

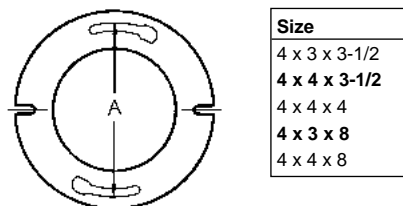

**TWO WAY CLEANOUT**

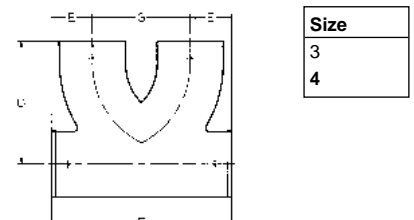



**NO-HUB ASA GROUP 022  
 SPECIALTIES & TRAPS, TRANSITION COUPLINGS**

**TWO WAY CLEANOUT**  
 East Bay Code

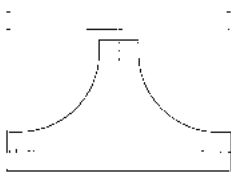

Size
4

**TWO WAY BAFFLE CLEANOUT**

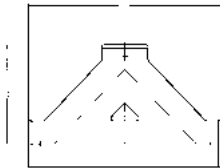

Size
3 x 3 x 4
4 x 3 x 4
4 x 4 x 4

**UPRIGHT WYE**  
 Wide Center-Florida Special

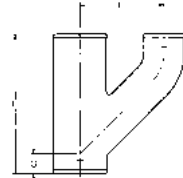

Size
3
4 x 2
4

**UPRIGHT WYE**

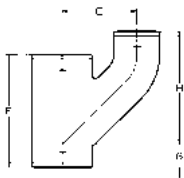

Size	Size
2	4
3 x 2	5 x 2
3	5 x 3
4 x 2	5
4 x 3	

**CAST IRON-TO-COPPER TRANSITION COUPLINGS**



Size
2 x 1-1/2
2 x 2
3 x 1-1/2
3 x 2
3 x 3

**THREADED OR NO-HUB SIDE INLET P-TRAPS**

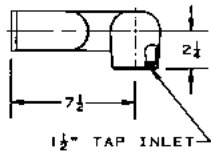

1 1/2" TAP INLET



9-344  
 (LEFT HAND)

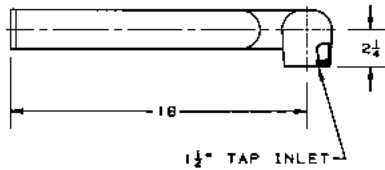

1 1/2" TAP INLET



9-344 (18)  
 (LEFT HAND)

Description
9-344-LH
9-344-RH
9-344-LH (18)
9-344-RH (18)

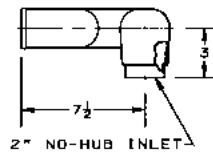

2" NO-HUB INLET



9-345  
 (LEFT HAND)

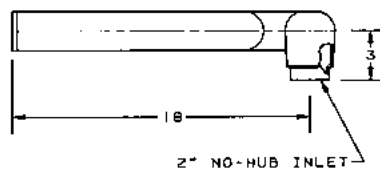

2" NO-HUB INLET

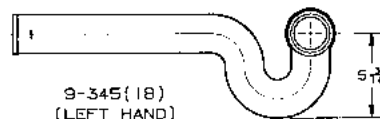

9-345 (18)  
 (LEFT HAND)

Description
9-345-LH
9-345-RH
9-345-LH (18)
9-345-RH (18)



**SV (SERVICE) ASA GROUP 021 BENDS**

**QUARTER BEND**

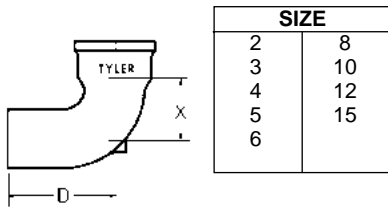

**EIGHTH BEND**

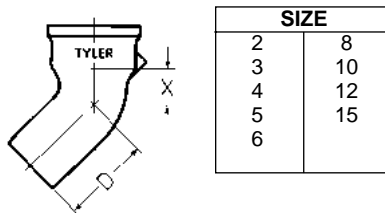

**SIXTH BEND**

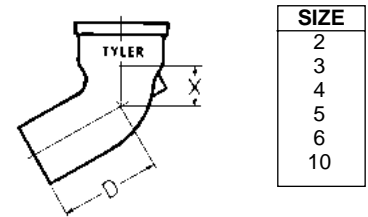

**SIXTEENTH BEND**

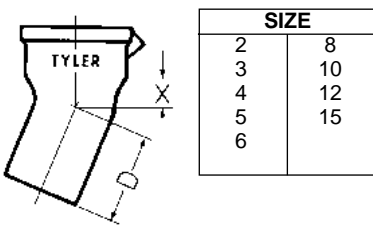

**QUARTER BENDING W/Low Heel Inlet**

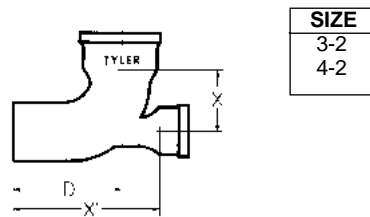

**QUARTER BEND REDUCING**

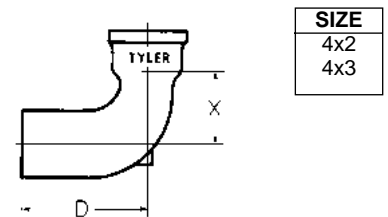

**LONG QUARTER BEND**

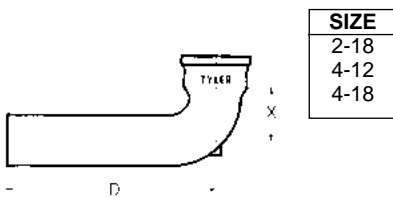

**LONG EIGHTH BEND**

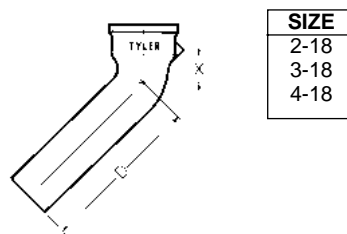

**SINGLE HUB RETURN BEND**

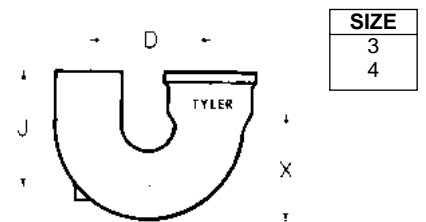

**Sweeps**

**LONG SWEEP BEND**

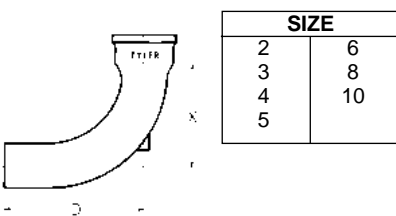

**LONG SWEEP BEND REDUCING**

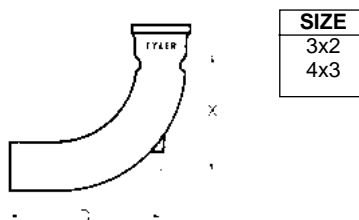

**SHORT SWEEP BEND**

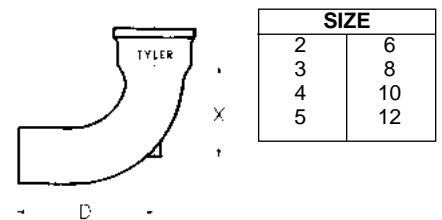



SV (SERVICE) ASA GROUP 021  
Y'S, COMBINATIONS, TEES, "H" BRANCHES, CROSSES, WYES

**SAN TEE**

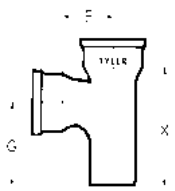

SIZE		
2	6x3	10
3x2	6x4	12x6
3	6	12x8
4x2	8x4	12x10
4x3	8x6	12
4	8	15x12
5x4	10x4	15
5	10x6	
6x2	10x8	

**WYE**

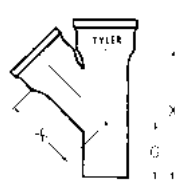

SIZE		
2	6x5	12x5
3x2	6	12x6
3	8x4	12x8
4x2	8x5	12x10
4x3	8x6	12
4	8	15x4
5x2	10x3	15x6
5x3	10x4	15x8
5x4	10x5	15x10
5	10x6	15x12
6x2	10x8	15
6x3	10	
6x4	12x4	

**COMBINATION**

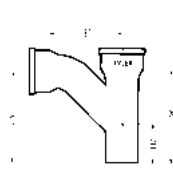

SIZE	
2	5
3x2	6x2
3	6x3
4x2	6x4
4x3	6
4	8x4
5x2	8x6
5x3	8
5x4	

**SAN TEE**  
**W/2" Hub Side Openings**

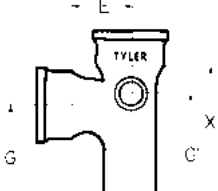

SIZE
3R
3L
4R
4L
3R&L
4R&L

**WYE**  
**W/2" Hub Side Opening**

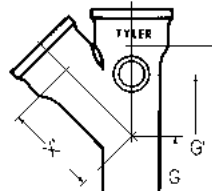

SIZE
4R
4L

**COMBINATION**  
**W/2" Hub Side Opening**

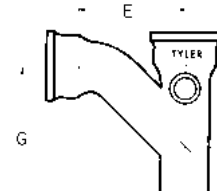

SIZE
4R
4L

**"H" BRANCH**

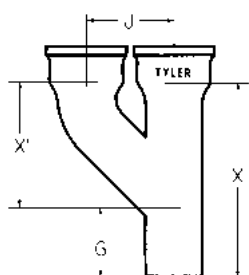

SIZE
2"
3"X2"
3"
4"X3"
4"

**STRAIGHT TEE**

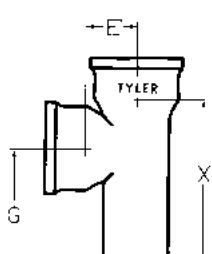

SIZE
3X2
3
4X2
4X3
4
6X4

**SAN CROSS**  
**W/2" SIDE OPENING**

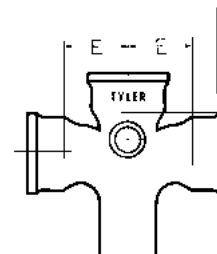

SIZE	Side Openings
4"	(1 Side)
4"	(2 Sides)

**SAN CROSS**  
**(No Baffle)**

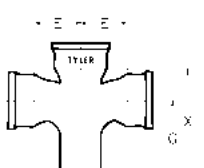

SIZE	
2	4x3
3x2	4
3	5x4
4x2	8x4

**DOUBLE WYE**  
**W/2" Hub Side Opening**

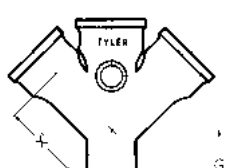

SIZE
4

**TAPPED WYE**

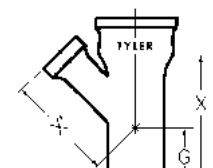

SIZE
3x2
4x1 1/2
4x2





**SV (SERVICE) ASA GROUP 021**  
**WYES, COMBINATIONS, TEES, CROSSES,**  
**CLEANOUTS, HUBS, INCREASERS**

**DOUBLE WYE**

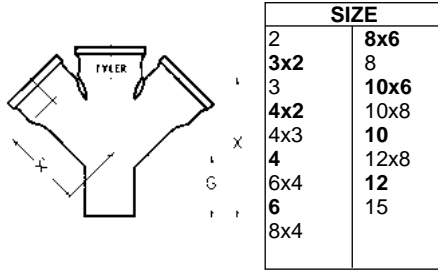

**TAPPED SAN TEE**

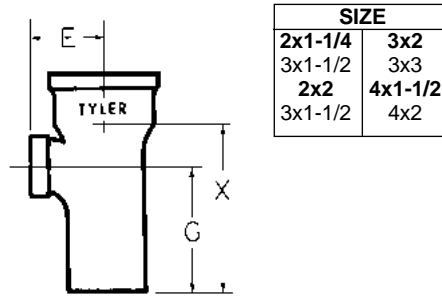

**STRAIGHT TAPPED TEE**

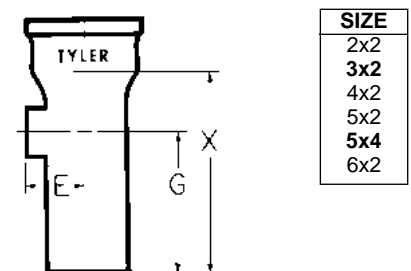

**DOUBLE COMBINATION**

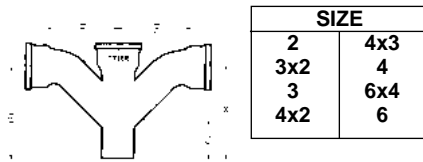

**TAPPED SAN CROSS**

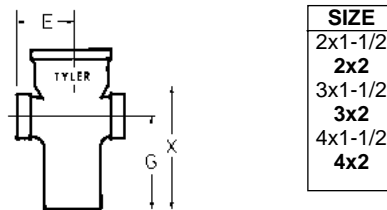

**STRAIGHT TAPPED CROSS**

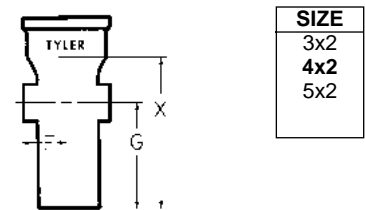

**DOUBLE COMBINATION W/2" Hub Side Opening**

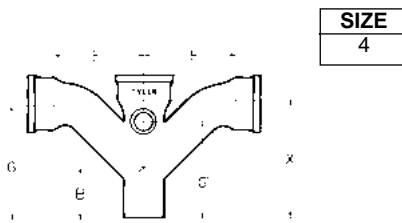

**TWO-WAY CLEANOUT**

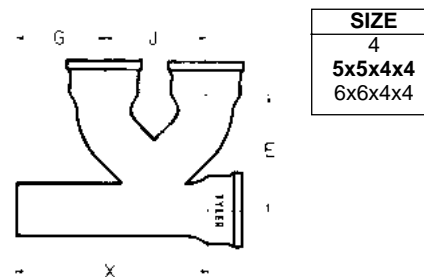

**DOUBLE HUB FITTING**

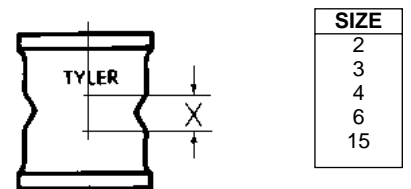

**TWO-WAY CLEANOUT Memphis Code**

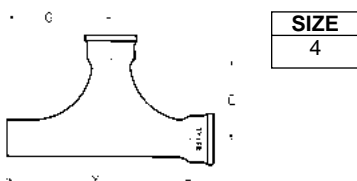

**LONG PLAIN INCREASER**

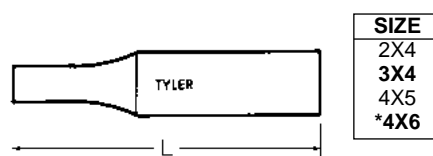

**REGULAR INCREASER**

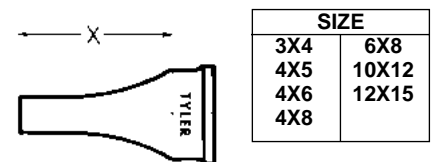

\*Not Suitable for Ty-Seal Joint



**SV (SERVICE) ASA GROUP 021  
INCREASERS, REDUCERS, PLUGS, TRAPS, FERRULES, ADAPTORS**

**Reducer**

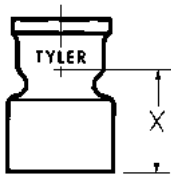

SIZE	
3 x 2	10 x 4
4 x 2	10 x 5
4 x 3	10 x 6
5 x 4	10 x 8
6 x 2	12 x 4
6 x 3	12 x 6
6 x 4	12 x 8
6 x 5	12 x 10
8 x 3	15 x 6
8 x 4	15 x 8
8 x 5	15 x 10
8 x 6	15 x 12

**Pipe Plug**



SIZE	
2	8
3	10
4	12
6	15

**Tapped Long Increaser**

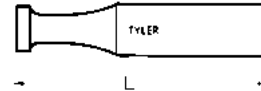

SIZE	L
2 x 4	24

**"P" Trap  
w/ 1/2" Heel Tap**

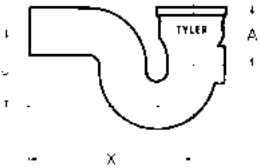

SIZE
2
3
4

**"P" Trap**

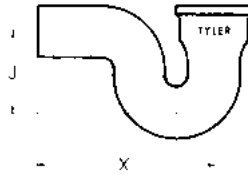

SIZE	
2	6
3	8
4	10
5	

**Running Trap**

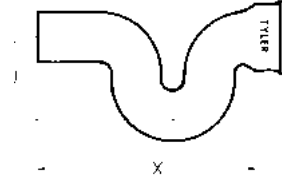

SIZE
4
6

**Running Trap  
w/ Hub Vent**

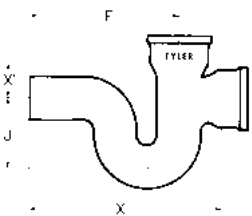

SIZE	(Vents)
3	(3)
4	(4)
5	(4)
6	(4)
6	(6)
8	(6)
10	(8)
12	(10)
15	(12)

**Running Trap  
w/ 2 Hub Vents**

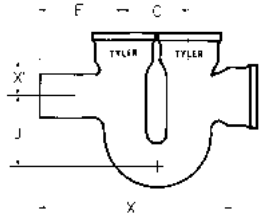

SIZE	(Vents)
3	(3-3)
4	(4-4)
5 x 4	(4-4)
5	(4-4)
6	(4-4)
6	(6-6)
8	(6-6)
10	(8-8)
12	(10-10)
15	(12-12)

**Deep Seal "P" Trap**

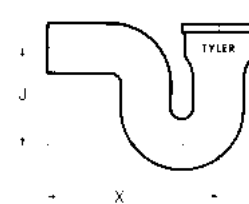

SIZE
2
3
4
6

**2-11 Standard Ferrule  
(Less Plug)**

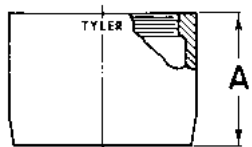

Pipe Size	Tap Size
2	1 1/2
3	2 1/2
4	3
4	3 1/2
5	4
6	5
8	6
10	6
12	6
15	6

**2-11 Standard Ferrule  
w/ Type A Plug**

Pipe Size	Tap Size
2	1 1/2
3	2 1/2
4	3
4	3 1/2
5	4
6	5
8	6
10	6
12	6
15	6

**2-41 Spigot Adaptor  
(SV or No-Hub)**

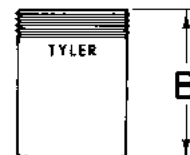

SP-IPS
2-2
3-3
4-4



**SV (SERVICE) ASA GROUP 021**  
**CLEANOUTS, ADAPTORS, FLANGES, CLOSET BENDS**

**Insertable Joint (SV Only)**

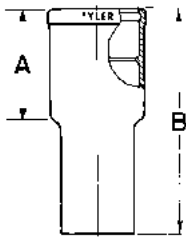

SIZE
3
4
6

**2-20 Extension Cleanout (less plug) (SV or No-Hub)**



SIZE-LENGTH
4-8
4-12

**2-40 Hub Adaptor Not Suitable for Ty-Seal®**

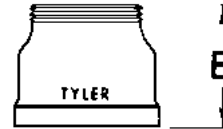

Hub-IPS
2-2
3-3
4-4

**2-70 Test Tee (SV Less Plug)**

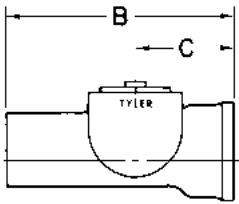

Pipe Size	Tap Size
2	2
3	3
4	3 1/2
*4	3 1/2
4	4
*4	4
5	5
6	6
8	6
8	8
10	10

\*Short Laying Length

**2-252TS Torque Set Closet Flange Fits 4" No-Hub or SV Pipe**

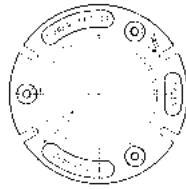

Part	Size
2-252TS	4 x 2 Torque Set
2-252TY	4 Ty-Seal Hub*

**2-252 Closet Flange (Caulk Joint Application)**

Regular

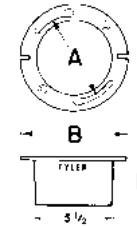

Size x Height
4 x 1
4 x 1 1/2
4 x 2
*4 x 2
4 x 2 1/2
4 x 3
*4 x 4
4 x 5
4 x 6

\*Portland Code

**2-252 Closet Flange (Caulk Joint Application)**

Offset 2"

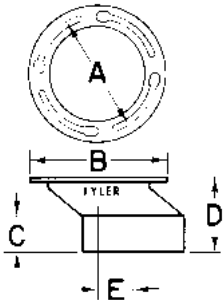

Size x Height
4 x 2, 1" Offset
4 x 4, 1" Offset

**2-253 Plain End Closet Bends**

Size	Dimensions	
	A	B
3	16	16
4	4	12
4	4	14
4	4	16
4	4	18
4	6	12
4	6	15
4	6	16
4	6	18
4	8	12
4	8	16
4	10	12
4	10	16
4	10	18
4	12	12
4	12	14
4	12	16
4	12	18
4	14	16
4	14	18
4	16	16
4	16	8
4	18	18

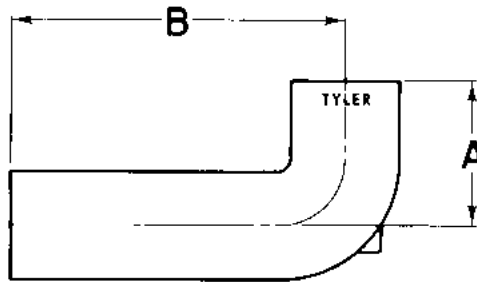

**2-254 Plain End Reducing Closet Bends**

Size	Dimensions	
	A	B
4 x 3	6	12
4 x 3	6	15
4 x 3	6	16
4 x 3	6	18
4 x 3	8	16
4 x 3	10	12
4 x 3	10	15
4 x 3	10	18
4 x 3	12	12
4 x 3	12	18
4 x 3	16	16
4 x 3	18	18