

Victaulic IPS CARBON STEEL PIPE GROOVED FITTINGS

Victaulic offers a broad line of fittings in sizes through 24" (610.0 mm) in a variety of straight and reducing styles. Most standard fittings are cast of durable ductile iron to precise tolerances. Victaulic standard fittings pressure ratings conform to the ratings of Victaulic Style 77 couplings.

Stainless Steel—Grooved end fittings are available in Schedule 10 Type 316 stainless steel (Schedule 5, 40 and Type 304 optionally available) in various sizes. *Fitting center-to-end dimensions will vary depending upon type and schedule.*

Aluminum—Grooved end fittings are available in aluminum alloy 356 T6, in sizes from 1 - 8" (33.7 - 219.1 mm).

Fittings—Ductile Iron (except as noted)

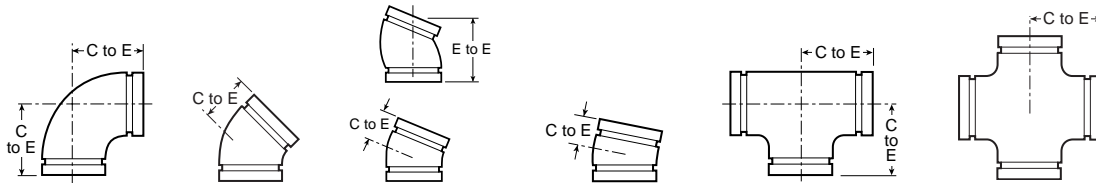

SIZE Nominal Inches	No. 10 90° Elbow		No. 11 45° Elbow		No. 12 22-1/2° Elbow		No. 13 11-1/4° Elbow		No. 20 Tee		No. 35 Cross (sw)	
	C to E Inches	Aprx. Wgt. Ea. Lbs.	C to E Inches	Aprx. Wgt. Ea. Lbs.	C to E Inches	Aprx. Wgt. Ea. Lbs.	C to E Inches	Aprx. Wgt. Ea. Lbs.	C to E Inches	Aprx. Wgt. Ea. Lbs.	C to E Inches	Aprx. Wgt. Ea. Lbs.
3/4	2.25	0.5	1.50	0.5	1.63 sw	—	1.38 sw	—	2.25	0.6	2.25	0.9
1	2.25	0.6	1.75	0.6	3.25 @	0.6	1.38 sw	0.3	2.25	1.0	2.25	1.3
1-1/4	2.75	1.0	1.75	0.9	1.75	0.8	1.38 sw	0.5	2.75	1.5	2.75	2.1
1-1/2	2.75	1.2	1.75	0.9	1.75	0.8	1.38 sw	0.5	2.75	2.0	2.75	2.5
2	3.25	1.8	2.00	1.3	3.75 @	1.4	1.38	1.0	3.25	3.0	3.25	3.8
2-1/2	3.75	3.2	2.25	2.2	4.00 @	2.3	1.50	1.1	3.75	4.3	3.75	6.1
76, 1 mm	3.75	3.7	2.25 sw	3.4	—	—	—	—	3.75	5.2	—	—
3	4.25	4.5	2.50	3.1	4.50 @	3.1	1.50	2.1	4.25	6.8	4.25	10.5
3-1/2	4.50	5.6	2.75	4.3	2.50 sw	4.0	1.75 sw	2.7	4.50	7.9	4.50	11.5
4	5.00	7.1	3.00	5.6	2.88	5.6	1.75	3.6	5.00	11.9	5.00	15.8
108.0 mm	5.00	11.0	3.00	5.6	—	—	—	—	5.00	15.5	—	—
4-1/2	5.25 sw	10.0	3.13 sw	6.0	3.50	6.6	1.88 sw	4.2	5.25 sw	15.0	5.25	18.5
5	5.50	11.7	3.25	8.3	2.88 sw	7.8	2.00 sw	5.0	5.50	17.8	5.50	20.0
133.0 mm	5.50	11.7	3.25	8.3	—	—	—	—	5.50	17.8	—	—
139.7 mm	5.50	11.7	3.25	8.3	—	—	—	—	5.50	17.8	—	—
6	6.50	17.2	3.50	10.8	6.25@	12.2	2.00	7.0	6.50	25.7	6.50	28.0
159.0 mm	6.50	18.6	3.50	10.8	—	—	—	—	6.50	27.1	—	—
165.1 mm	6.50	15.5	3.50	9.8	3.13	11.4	2.00	7.4	6.50	22.0	6.50	28.0
8	7.75	29.9	4.25	20.4	7.75 @	20.0	2.00	10.1	7.75	47.6	7.75	48.0
10	9.00	63.3	4.75	37.5	4.38 sw	30.0	2.13 sw	11.8	9.00	99.0	9.00	121.5
12	10.00	74.0	5.25	66.7	4.88 sw	40.0	2.25 sw	29.3	10.00	133.0	10.00	110.0
14	#	#	#	#	5.00 sw	46.0	3.50 sw	32.0	11.00 sw*	151.0	11.00	198.0
16	#	#	#	#	5.00 sw	58.0	4.00 sw	42.0	12.00 sw*	188.0	12.00	250.0
18	#	#	#	#	5.00 sw	58.0	4.50 sw	53.2	15.50 sw*	263.0	15.50	350.0
20	#	#	#	#	6.00 sw	78.6	5.00 sw	65.0	17.25 sw*	339.0	17.25	452.0
24	#	#	#	#	7.00 sw	140.0	6.00 sw	60.0	20.00 sw*	473.0	20.00	795.0

#14", 16", 18", 20", 24" (355.6) elbows (90°, 45°) are 1-1/2D long radius forged steel elbows No. 100 and No. 110.

For 28-42" fittings.

For 1D radius elbows contact Victaulic. Long radius 3D, 5D and 6D are available, request 07.02

(s) Steel

(sw) Segmentally welded steel

@ Gooseneck design, end-to-end dimension

* Cast ductile iron fittings available, contact Victaulic for details.



IPS CARBON STEEL PIPE GROOVED FITTINGS

No. 33
 True Wye
 Segmentally Welded Steel

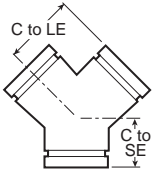

No. 29M
 Tee with Thd. Branch
 Ductile Iron

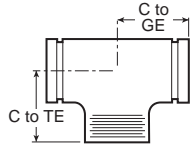

No. 100 & No. 110
 90° and 45° Long Radius Elbows 1-1/2 D
 Ductile Iron

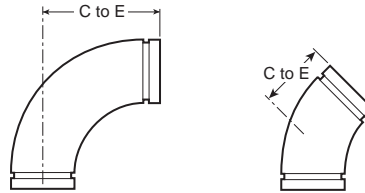

No. 48
 Hose Nipple (U.S.)
 Steel

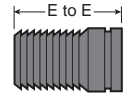

3D Cast Elbows
 For Abrasive Services

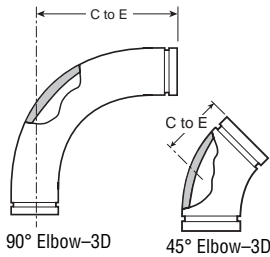

Long Radius Elbows
 Steel

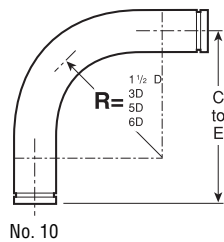

No. 41 – ANSI 125
No. 45 – ANSI 150
No. 46 – ANSI 300
 Flanged Adapter Nipples

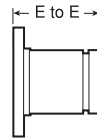

No. 80
 Female Threaded Adapter
 Ductile Iron

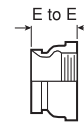

No. 30
 45° Lateral
 Segmentally Welded Steel

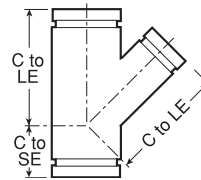

No. R-10
 Reducing Base Support Elbows
 Ductile Iron

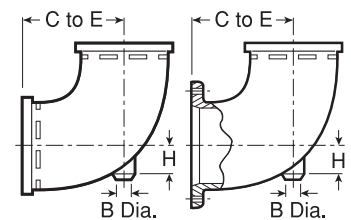

Fabricated Fittings
 Steel

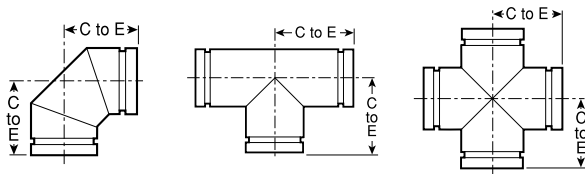

Victaulic offers a broad line of segmentally welded fittings in sizes through 24" (610.0 mm) in a variety of straight and reducing styles. Fittings are fabricated of ASTM A-53 carbon steel, or other materials by special order. Victaulic segmentally welded fittings pressure

ratings conform to the ratings of Victaulic Style 77 couplings. All fittings are grooved to permit fast installation without field preparation. The grooved design permits flexibility for easy alignment.

No. 60, 40, 42, 43
 Cap and Nipples
 Cap – Ductile Iron
 Nipples – Steel

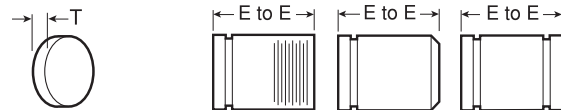

Victaulic **IPS CARBON STEEL PIPE GROOVED FITTINGS**

No. 52
 Reducer Threaded Small End



No. 53,54,55
 Swaged Nipples* – Steel

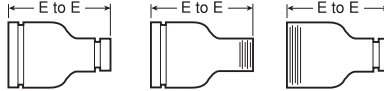

*Also available in threaded small end No. 54 or threaded large end No. 55.

No. 50 & No. 51
 Concentric/Eccentric Reducers
 Steel

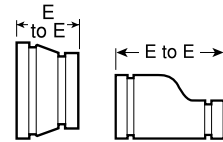

No. 25 & No. 29
 Reducing Tees
 Segmentally Welded Steel

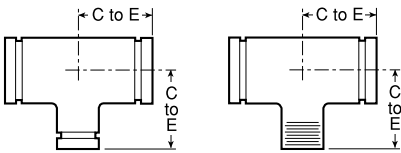

No. 18 & No. 19
 Adapter Elbows
 Ductile Iron

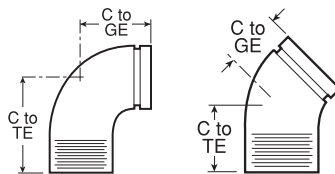

No. 61
 Bull Plug
 Steel

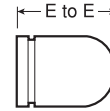

No. 21
 Bullhead Tee
 Ductile Iron

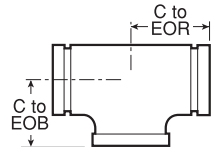

No. 27
 Sandpipe Tee
 Ductile Iron

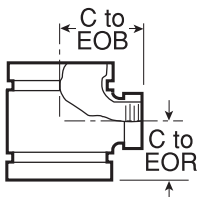

No. 32
 Tee Wye
 Segmentally Welded Steel

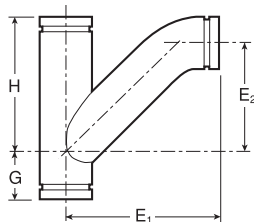

No. 30-R
 Reducing Lateral
 Segmentally Welded Steel

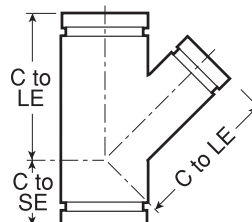

No. 32-R
 Reducing Tee Wye
 Segmentally Welded Steel

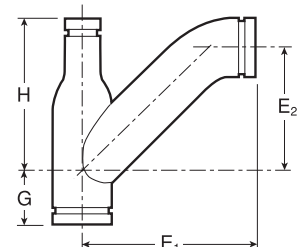

Victaulic IPS CARBON STEEL PIPE GROOVED COUPLINGS

Style 07
 Zero-Flex® Rigid Coupling



The unique angle-pad design of Zero-Flex® Style 07 adjusts to standard pipe and roll or cut groove tolerances, positively clamping the pipe to resist flexural and torsional loads. Wider key section fills more of the groove area.

Style 77
 Standard Flexible Coupling



Style 77 couplings are designed with cross-ribbed construction to provide a strong component for pressure piping systems. Sizes 3/4-12" (26.9 - 323.9 mm) are two-piece housings. Sizes 14 - 22" (355.6 - 559.0 mm) are cast in four identical segments, with larger sizes cast in six segments.

Style 770
 Standard Coupling for Roll Grooved Pipe



Style 770 couplings are designed for joining large diameter piping systems. Ranging in size from 28" (711.0 mm) to 42" (1067.0 mm), Style 770 is ideal for roll grooved IPS black or galvanized steel and stainless steel systems.

Style 75
 Flexible Coupling



Style 75 is available where moderate pressures are expected or weight considerations are a factor. Up to 50% lighter in weight than the Style 77, the Style 75 coupling is recommended for service up to 500 PSI (3450 kPa) depending on size.

Style 741
 Vic-Flange® Adapter
 ANSI Class 125 & 150 Flange
 Sizes 2 - 12" (60.3 - 323.9 mm)



Style 741 Vic-Flange adapter is designed for directly incorporating flanged components with ANSI CL 125 or CL 150 bolt hole patterns into a grooved pipe system. Sizes 2 - 12" (60.3 - 323.9 mm) are hinged for easy handling with integral end tabs to facilitate assembly.

Style 743
 Vic-Flange® Adapter
 Grooved pipe adapter to
 ANSI Class 300 flanges



Vic-Flange Style 743 flange-to-groove adapter permits direct connection of ANSI Class 300 raised face flanged components. It can be used with flat-face flanges by removing the raised projections on the outside face of the flange.

Style 741
 Vic-Flange® Adapter
 ANSI Class 125 & 150 Flange
 Sizes 14 - 24" (355.6 - 610.0 mm)



Style 741 Vic-Flange adapter is designed for directly incorporating flanged components with ANSI CL. 125 or CL. 150 bolt hole patterns into a grooved pipe system. Sizes 14 - 24" (355.6 - 610.0 mm) are cast in four (4) identical segments which interconnect as assembly is completed.

Style HP-70
 Rigid Coupling



Style HP-70 is designed to clamp the pipe, thus providing an essentially rigid joint. To achieve rigidity it is necessary to torque the bolts on sizes 2 - 4" (60.3 - 114.3 mm) to 60 - 80 ft. lbs. (80 - 110 N•m); 14 - 16" (355.6 - 406.4 mm) to 600 and 700 ft. lbs. (800 and 950 N•m), respectively. The nuts on the 14 & 16" (355.6 & 406.4 mm) sizes are torqued to 600 & 700 ft. lbs. (810 & 950 N•m), respectively. All other sizes must be bolted securely metal-to-metal.

Style HP-70ES
 Coupling with Fire-R™ Gasket



The Victaulic HP-70ES EndSeal coupling has an oil-resistant nitrile gasket with a high modulus for resistance to extrusion. The Fire-R™ gasket features a stainless steel inner leg that provides a secondary closure. Style HP-70ES with Fire-R gasket is fire tested to API 607 standards.

Victaulic IPS CARBON STEEL PIPE GROOVED VALVES

Vic®-300
 Butterfly Valves



Vic-300 butterfly valves are designed for services from vacuum to 300 PSI (2065 kPa). Vic-300 butterfly valves feature a narrow profile disc design with a smooth, coated inner body which combine for superior flow characteristics. This combination results in extremely low break-away torque, reducing gear operator and actuator sizing and costs. Standard polyphenylene sulfide blend (PPS) coating accommodates a wide variety of severe services (epoxy coating or full stainless body are available for severe services). The dual-seal disc provides bubble-tight sealing up to 300 PSI (2065 kPa) in both directions without added valve modifications or cost.

Series 700
 Butterfly Valves



Victaulic Series 700 butterfly valves are designed for bubble-tight shut-off to 200 PSI (1400 kPa). Two-piece stem permits narrow disc design for low pressure drop performance and is self-centering for positive shut-off. Valves are available with EPDM for water service to +230°F (+110°C) or nitrile for oil services to +150°F (+66°C) liners. Refer to Liner/Disc Selection for general service recommendations.

Series 712 & 713
 Swinger® Check Valve



Series 712 Swinger® swing check valves have large closure access bonnet for internal coating. A 316 stainless steel clapper features a bonded bumper for coating protection. Series 712 swing check valves are rated to 300 PSI (2065 kPa) service. A 2" (60.3 mm) size stainless steel model is also available. Series 713 is available in 2" (60.3 mm) size rated to 1000 PSI (6900 kPa).

Series 716
 Vic-Check® Valves

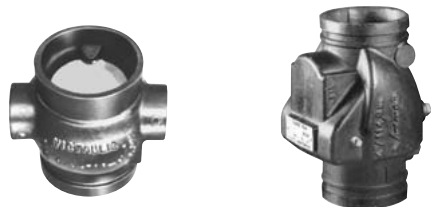

The Series 716 check valve is available in sizes 2-1/2–14" (73.0–355.6 mm). It is a spring assisted single disc design that achieves a leak-free seal with as little as 5 ft. (1.5 m) of head and can be installed in both horizontal and vertical positions. Every valve is factory tested to its working pressure of 300 PSI (2065 kPa). Drains are optional both upstream and downstream of the disc.

Series 779
 Venturi-Check Valves



The Victaulic Series 779 Venturi-Check valves provide a versatility of service unlike any flow measuring device. The CAD-designed hydrodynamic inlet profile provides a natural venturi as part of the valve. The inlet is drilled, tapped and plugged, ready to receive the flow kit (included). The venturi-like taps provide much greater measurement accuracy than taps placed across the valve seat. Valve turbulence and interference across the valve seat need not be a consideration. Twin taps on both sides of the valve provide positioning of measurement outlets for convenient meter connection. Every valve is factory tested and rated to 300 PSI (2065 kPa) working pressure. All sizes can be installed in horizontal or vertical position and provide leak-free sealing under conditions as low as five feet (1.5 m) of head pressure.

Series 377
 Vic-Plug™ Balancing Valve



Series 377 Vic-Plug™ balancing valve is the first eccentric grooved end plug valve for throttling services. Victaulic Style 307 Transition couplings are available (3–12"/88.9–323.9 mm) to directly connect Vic-Plug valves to grooved end steel and other IPS pipe.

Victaulic CIRCUIT BALANCING VALVES

The TA Hydronics* balancing valves offer a reliable, simple and cost effective way to measure and balance all flow rates. Full throttling range is achieved by 4, 8, 12 or 16 full turns of the hand wheel, enabling a more precise setting.

Actual pressure drops are difficult to establish by calculation. Water flows are frequently incorrect. They can be corrected easily by

regulating the desired water flow with TA Hydronics Globe Style Balancing Valves. By measuring the pressure drop across measuring ports at a particular hand wheel setting, the water flow for the valve size can be read easily from the appropriate pressure drop graph.

Series 785, 786 and 787 have full Ametal* copper alloy bodies which obviate dielectric

connections. Series 788 and 789 have ductile iron bodies and Ametal trim.

All valves are rated to +250°F (+120°C) and -22°F (-30°C), but service will be governed by the connecting coupling gasket ratings.

*Registered trademark of TA Hydronics.

Series 785

TBV-S

Sweated End "Mini" (125 PSI)

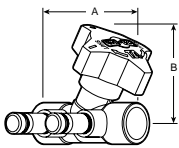

SIZE Nom. In. Actual mm	Dim.-In./mm		Aprx. Wgt. Ea. Lbs./kg
	A	Hgt. B†	
1/2 21.3	2.63 67.0	2.88 73.0	1.0 0.5
3/4 26.9	3.16 80.2	2.56 65.0	1.0 0.5

†Overall height with valve fully opened.

Series 786

STAS

Solder End (300 PSI)

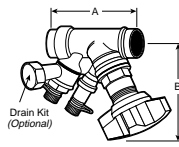

SIZE Nom. In. Actual mm	Dim.-In./mm		Aprx. Wgt. Ea. Lbs./kg
	A	Hgt. B†	
1/2 21.3	3.50 89.0	4.00 102.0	1.4 0.6
3/4 26.9	3.81 97.0	4.00 102.0	1.4 0.6
1 33.7	4.31 110.0	4.50 114.0	1.9 0.9
1-1/4 42.4	4.88 124.0	4.31 110.0	2.4 1.1
1-1/2 48.3	5.13 130.0	4.75 121.0	3.1 1.4
2 60.3	6.13 156.0	4.75 121.0	4.5 2.0

†Overall height with valve fully opened.

Series 787

STAD

NPT (Fem.) End (300 PSI)

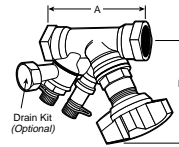

SIZE Nom. In. Actual mm	Dim.-In./mm		Aprx. Wgt. Ea. Lbs./kg
	A	Hgt. B†	
1/2 21.3	3.50 89.0	4.00 102.0	1.5 0.7
3/4 26.9	3.81 97.0	4.00 102.0	1.6 0.7
1 33.7	4.31 110.0	4.50 114.0	2.0 0.9
1-1/4 42.4	4.88 124.0	4.31 110.0	2.6 1.2
1-1/2 48.3	5.13 130.0	4.75 121.0	3.3 1.5
2 60.3	6.13 156.0	4.75 121.0	5.0 2.3

†Overall height with valve fully opened.

Series 787-U

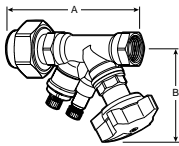

SIZE Nom. In. Actual mm	Dim.-In./mm		Aprx. Wgt. Ea. Lbs./kg
	A	Hgt. B†	
1/2 21.3	4.81 122	4.00 102	1.7 0.8
3/4 26.9	5.13 130	4.00 102	1.8 0.8
1 33.7	6.00 152	4.50 114	2.2 1.0

†Overall height with valve fully opened.

Series 788

STAF

Flanged End (250 PSI)

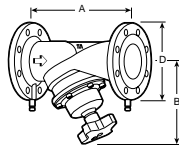

SIZE Nom. In. Actual mm	Dim.-In./mm		Aprx. Wgt. Ea. Lbs./kg
	A	Hgt. B†	
2-1/2 73.0	11.38 289.0	7.88 200.0	29.0 13.2
3 88.9	12.25 311.0	8.50 216.0	38.0 17.2
4 114.3	13.75 350.0	9.00 229.0	50.0 22.7
5 141.3	15.75 400.0	10.50 267.0	74.0 33.6
6 168.3	18.88 480.0	11.25 286.0	101.0 45.8
8 219.1	23.63 600.0	17.75 451.0	243.0 110.2
10 273.0	28.75 730.0	18.50 470.0	324.0 147.0
12 323.9	33.50 851.0	20.50 521.0	463.0 208.4

†Overall height with valve fully opened.

Series 789

STAG

Grooved End (300 PSI)

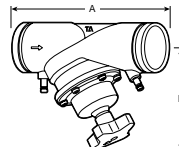

SIZE Nom. In. Actual mm	Dim.-In./mm		Aprx. Wgt. Ea. Lbs./kg
	A	Hgt. B†	
2-1/2 73.0	11.38 289.0	7.88 200.0	14.0 6.4
3 88.9	12.25 311.0	8.50 216.0	20.0 9.1
4 114.3	13.75 350.0	9.00 229.0	31.0 14.1
5 141.3	15.75 400.0	10.50 267.0	50.0 22.7
6 168.3	18.88 480.0	11.25 286.0	69.0 31.3
8 219.1	23.63 600.0	17.75 451.0	175.0 78.8
10 273.0	28.75 730.0	18.50 470.0	240.0 108.0
12 323.9	33.50 851.0	20.50 521.0	360.0 162.0

†Overall height with valve fully opened.

Victaulic IPS CARBON STEEL PIPE GROOVED END ACCESSORIES

Style 731
Suction Diffuser



Victaulic Style 731 Suction-Diffuser provides optimum flow conditions at the inlet side of the pump. Each suction diffuser is provided with a removable strainer and a fine mesh sleeve which acts as a start-up strainer. A 1-1/4" (42.4 mm) pipe support boss is provided for support and side taps for pressure measurement. A plug is also provided to allow for easy draining of the system. Victaulic Style 731 is rated at 300 PSI (2065 kPa) working pressure.

Style 730
Vic-Strainer® – Tee Type



Style 732
Vic-Strainer – Wye Type



Style 150
Mover® Expansion Joint



Style 155
Expansion Joint



Style 47
Dielectric Waterway Fittings



Clearflow* Dielectric Waterway fittings create a dielectric waterway by insulating the inside of the metal casing, thus inhibiting the internal formation of galvanic local cell corrosion between the dissimilar metals in the presence of water.

Clearflow fittings use materials which meet the requirements of ASTM F-492-77. Clearflow fittings are designed for continuous use at temperatures up to 230°F (110°C) and pressures up to 300 PSI (2065 kPa).



1. Inert, non-corrosive thermoplastic lining (NSF/FDA listed)
2. Patented ring-groove locks the steel casting to the thermoplastic lining, or molded liner with identifying roll marking on casing.
3. Zinc electroplated casing, threaded in accordance with American National Pipe Thread – Tapered (ANSI A1.20.1)

Style 47-GG
Grooved End Steel (IPS) to Grooved Copper (CTS) Transition Fitting



2 - 3" Sizes



4 - 8" Sizes

Style 47-GG
Grooved X Grooved

Style 47-GT and 47-TT



Style 47-GT
Grooved X Threaded



Style 47-TT
Threaded X Threaded

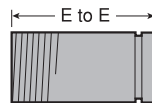

Grooved X Threaded

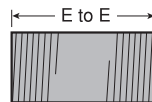

Threaded X Threaded

IPS Carbon Steel Pipe Hole Cut Products

Styles 920 & 920N
Mechanical-T® Bolted Branch Outlet

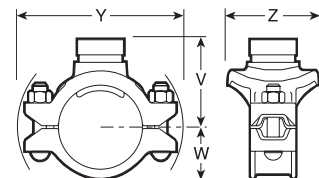

Styles 920 and 920N
w/Grooved Outlet

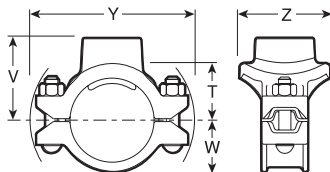

Styles 920 and 920N
w/Female Threaded Outlet

*Clearflow is a registered trademark of Perfection Corp.

Victaulic IPS CARBON STEEL PIPE HOLE CUT PRODUCTS

Style 923 Vic-Let™ Strapless Outlet



The Victaulic Style 923 Vic-Let™ outlet has integral lugs which insert into a hole cut in the pipe, gripping against the pipe's inside wall, while a nut threaded on the main body is tightened.

Style 923 Vic-Let outlets are rated at 300 PSI (2065 kPa) working pressure for standard weight steel pipe.

Style 924 Vic-O-Well™ Strapless Thermometer Outlet

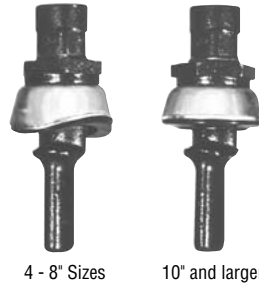

The Victaulic Style 924 Vic-O-Well™ outlet main body casting has integral lugs which insert into a hole, gripping against the I.D. wall, while a nut threaded on the main body. The Vic-O-Well outlet main body is machined internally to standard thread well dimensions. Both sizes are rated at 300 PSI (2065 kPa) working pressure on steel pipe.

IPS Carbon Steel Pipe Pressfit System

The Pressfit® System offers economy, speed and reliability for joining small diameter pipe for fire protection, heating/air conditioning and many other services.

Pressfit products for carbon steel pipe are externally zinc electroplated.

Pressfit carbon steel is not intended for use in open loop water systems.

The system incorporates Schedule 5 steel pipe from 3/4–2" (26.9–60.3mm), with a system of Pressfit couplings, elbows, tees, reducers and adapters. This system allows pipe assembly in seconds. A portable, hand-held electric or hydraulic tool assembles the fitting on the pipe with a permanent mechanical attachment.

The Pressfit System for carbon steel is BOCA listed – HVAC (Cat. 23) and Fire Protection

(Cat. 15). It is Listed by SBCCI PST and ESI in Report No. 9535.

Pressfit System products are rugged and reliable. They are UL/ULC Listed and FM Approved for 175 PSI (1200 kPa) fire protection service and rated to 300 PSI (2065 kPa) for heating water and other general services.

Pressfit System also available in stainless.

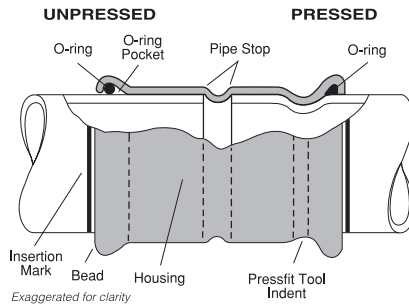

O-ring—Precisely molded compresses against pipe O.D.

Housing—Precision formed externally zinc electroplated carbon steel with integral pipe stop

Pipe Stop—Assures uniform take-out dimension and positions pipe for proper assembly (not on Slip Coupling)

O-ring Pocket—Sized to contain the o-ring, the pocket is deformed during assembly

Pressfit Tool Indent—Housing is uniformly compressed with the Pressfit Tool into a permanent mechanical engagement onto the pipe.

NOTE: Designers of systems exposed to potentially corrosive situations (high humidity, marine or process environments, etc.) should always consider use of protective coatings on any carbon steel piping products.

Style 505 Standard Coupling (P X P)

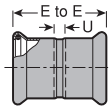

Style 506 Slip Coupling (P X P)

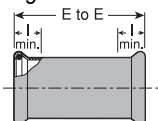

Style 510 90° Elbow (P X P)

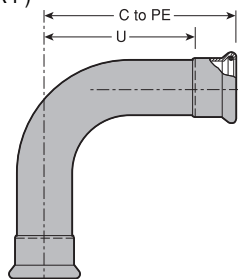

Style 511 45° Elbow (P X P)

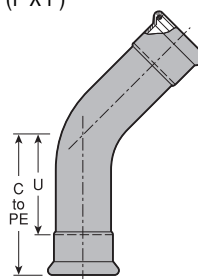

Style 509 Short Tangent 90° Elbow (P X P)

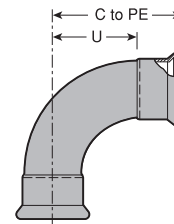

Style 509 Short Radius 90° Elbow Reducing (P X F)

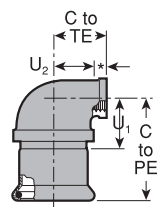

Victaulic IPS CARBON STEEL PIPE PRESSFIT SYSTEM

Style 520
Tee
(P X P X P)

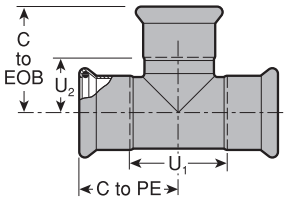

Style 520
Tee
Reducing Branch
(P X P X F)

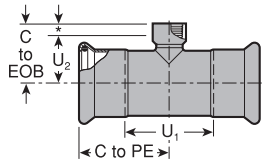

Style 520
End-of-Line Tee

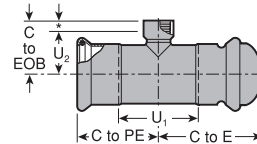

With Threaded Reducing Branch
(P X C X F)

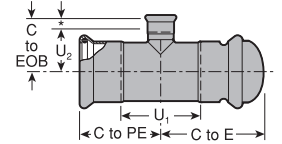

With Pressfit Reducing Branch
(P X D X P)

Style 522
Brass Body Ball Valve with
Carbon Steel Pressfit Ends
(P X P)

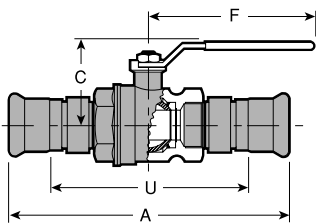

Style 535
Cross
(P X P)

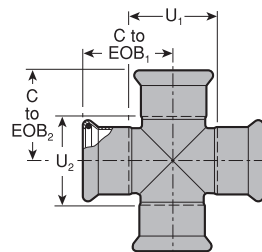

Style 550
Reducer Insert
(T X P)

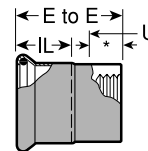

Style 580
Adapter Female
Threaded
(P X F)

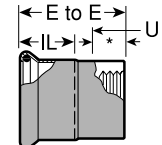

Style 580
Adapter Male Threaded
(P X M)

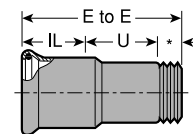

Approved Pipe

Products in the Pressfit carbon steel system are easily installed on approved Schedule 5 carbon steel pipe using the Pressfit tool.

The Pressfit System requires no special preparation of the pipe ends before assembly. Pipe should be square cut (± 0.030 ") and deburred, if

required, to prevent damage to the o-ring during assembly.

Pressfit System carbon steel products are designed for use only on approved Schedule 5 carbon steel pipe having a maximum yield strength of 45,000 PSI (310000 kPa) and maximum hardness of $R_b 70$.

Victaulic IPS CARBON STEEL PIPE PLAIN END SYSTEM

Style 99
Roust-A-Bout®
Coupling



The Style 99 Roust-A-Bout coupling consists of a durable ductile iron housing. Its curved, case-hardened steel jaws grip into the pipe when nuts are tightened to **full torque specifications**, and it requires no pipe end preparation.

Plain End Fittings

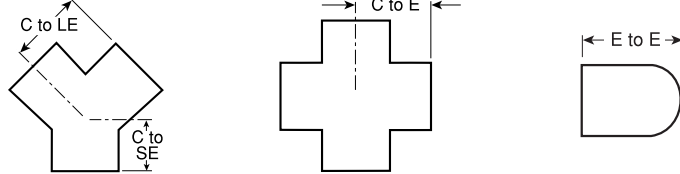

Long Radius Elbows

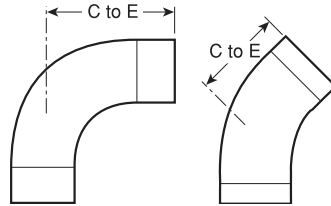

Long Tangent Elbows

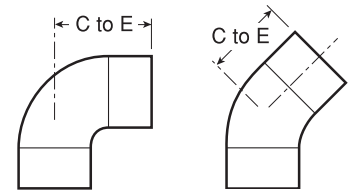

CTS Copper Tubing Grooved Piping System

TUBING – TYPE K, L, M, DWV

The Victaulic copper connection system is for joining large diameter copper tubing (CTS) in 2–8" (54.0–206.4 mm) sizes.

Patented angled pad design adjusts to standard tubing tolerances and provides positive clamp-

ing on the tubing to resist flexural and torsional loads.

The system uses a proven pressure-responsive synthetic rubber FlushSeal® gasket to seal on the outside diameter of the tubing. This means

no heat is required and no lead is used. The housing provides the gripping strength for pressure ratings up to 300 PSI (2065 kPa), depending on type and size of copper tubing.

Style 606
Coupling for Copper Tubing

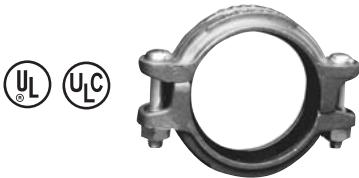

No. 650
Reducer



Groove x Groove

No. 652
Reducer

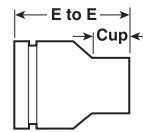

Groove x Copper Sweat

Style 641
Vic-Flange® Adapter for
Copper Tubing

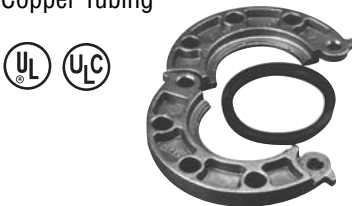

The Style 641 Vic-Flange® Adapter provides a direct connection from flanged components (Cl. 125 and Cl. 150 bolt hole pattern) to grooved copper tubing, with integral tabs to ease handling.

No. 660
Cap



No. 610, No. 611 & No. 620
Elbows and Tee

Victaulic copper fittings are full-flow, standard radius fittings, supplied roll grooved.

